

LONGITUDINAL VIEW PS

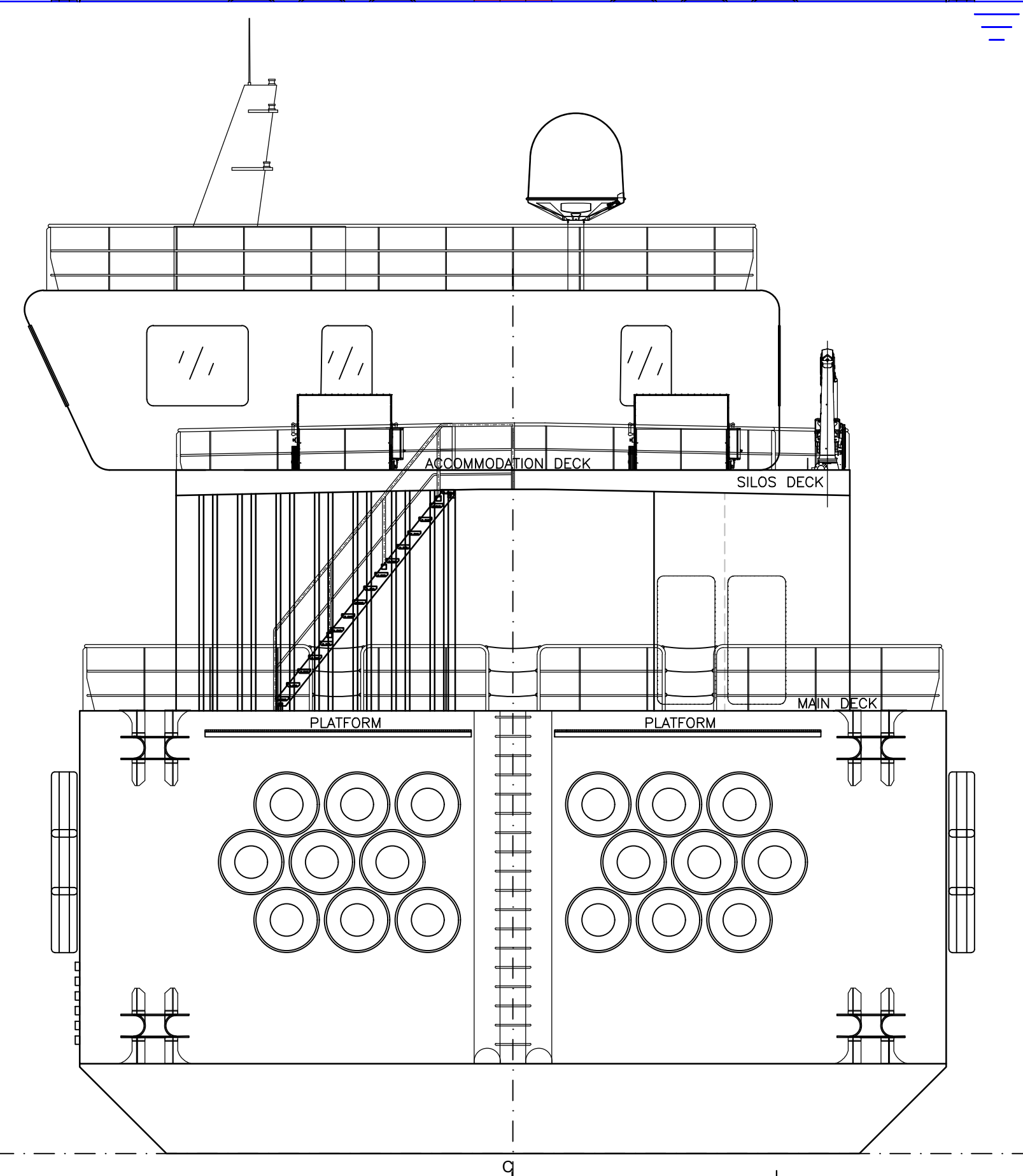

AFT VIEW

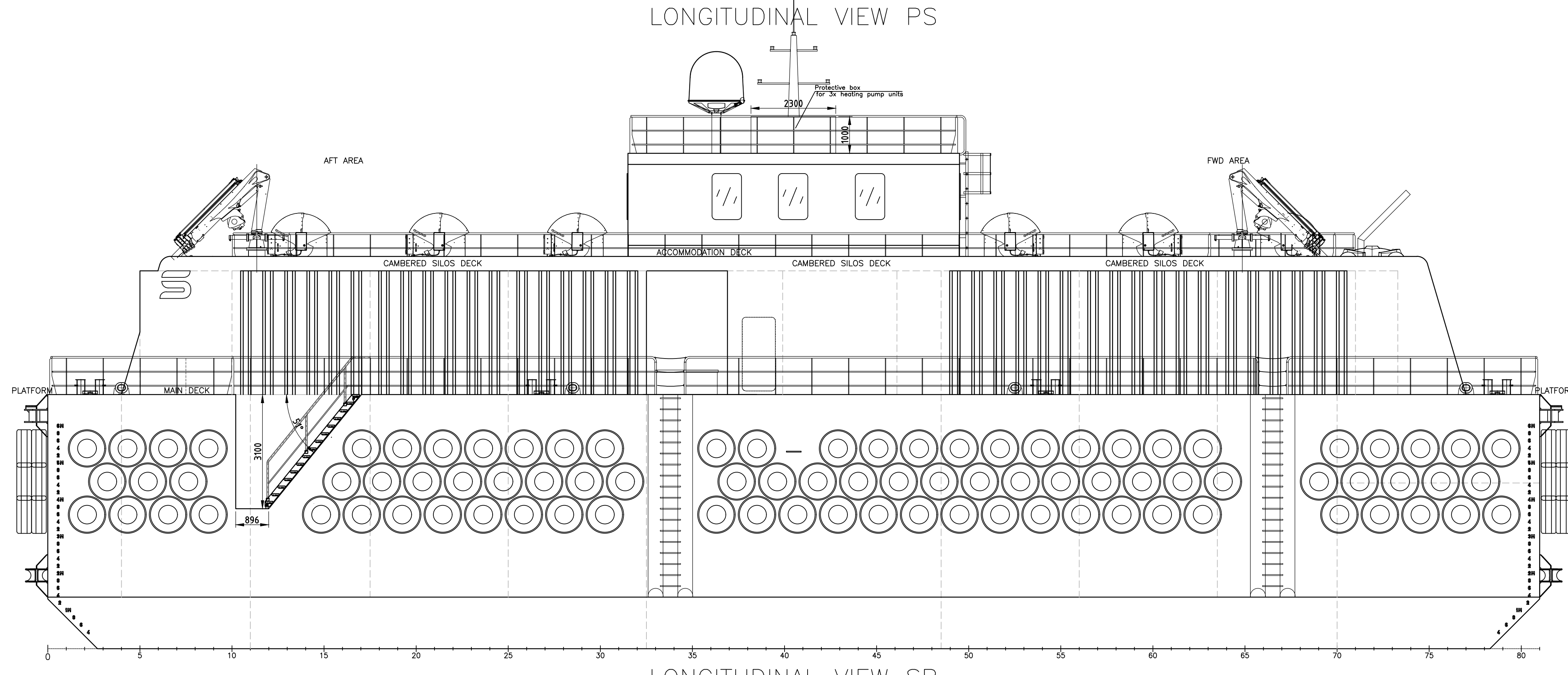

LONGITUDINAL VIEW SB

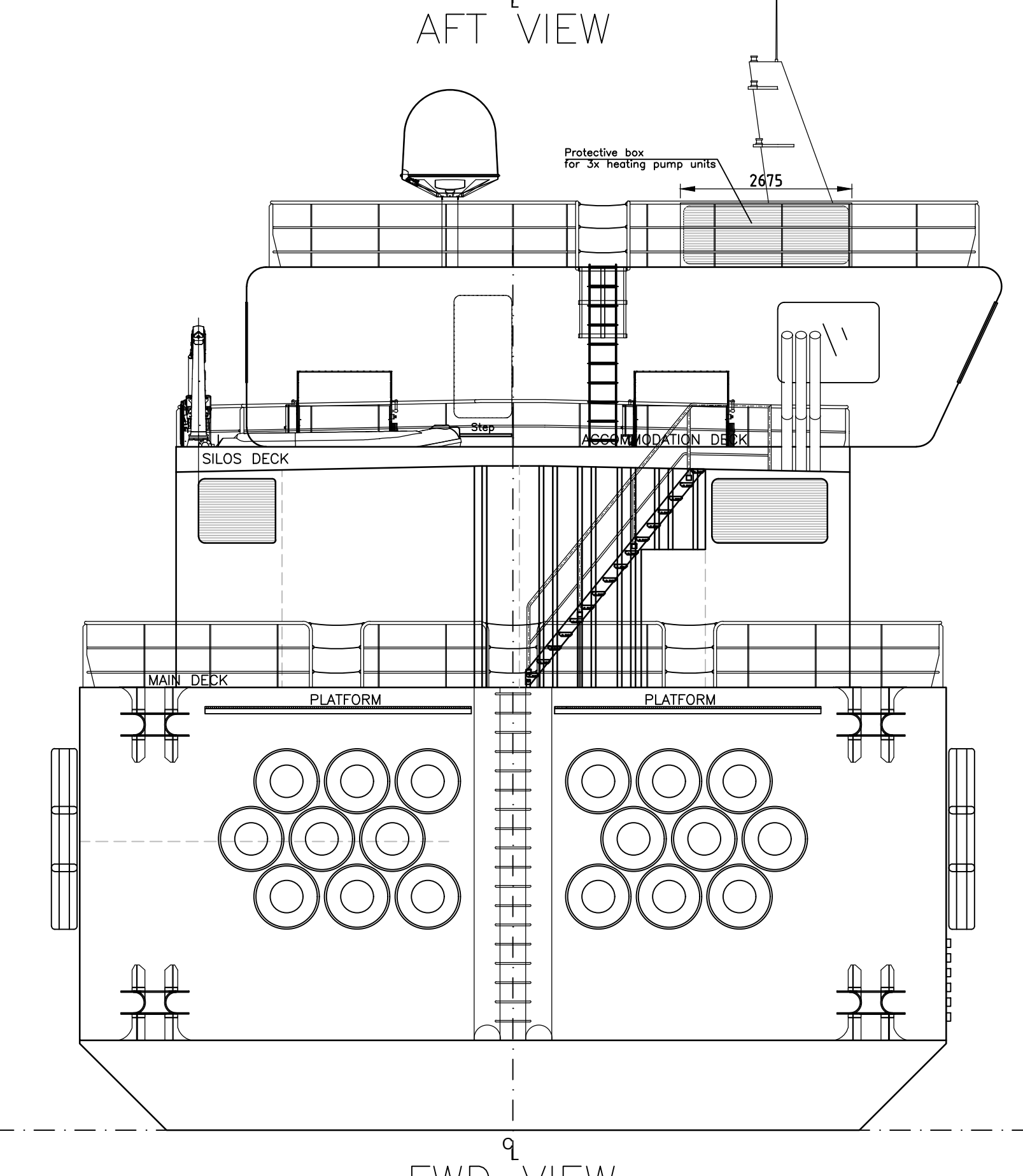

FWD VIEW

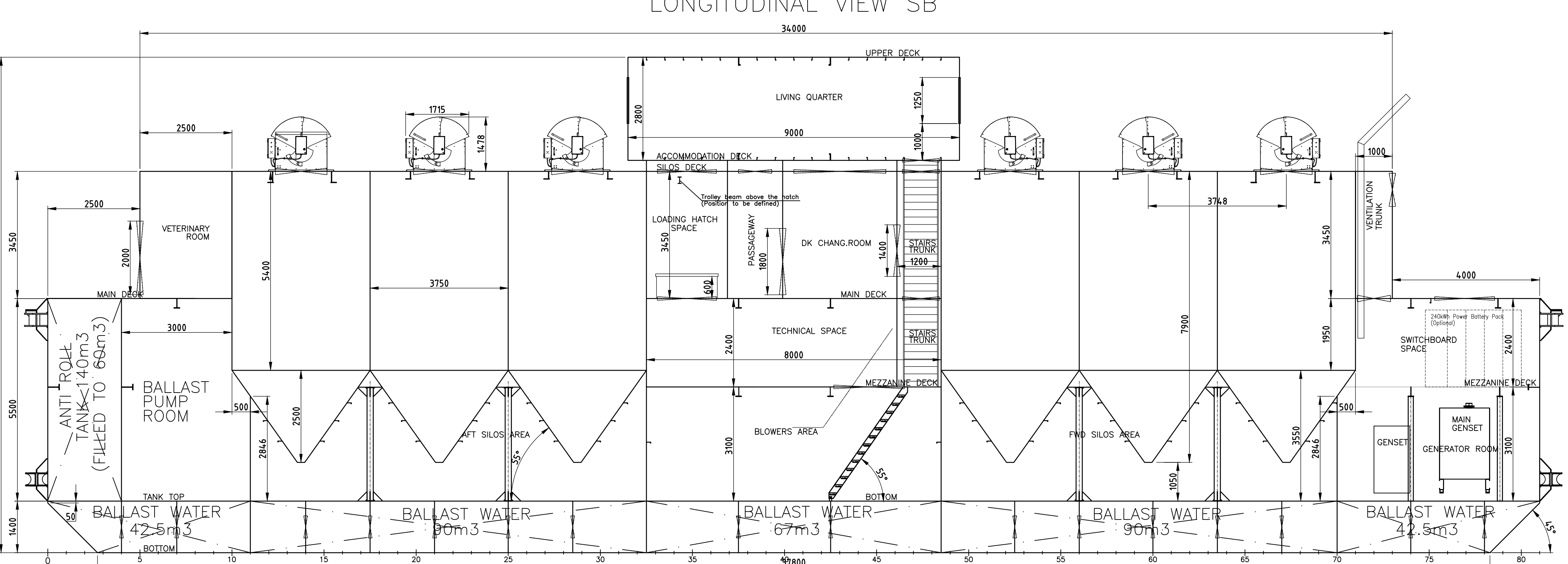

LONGITUDINAL SECTION

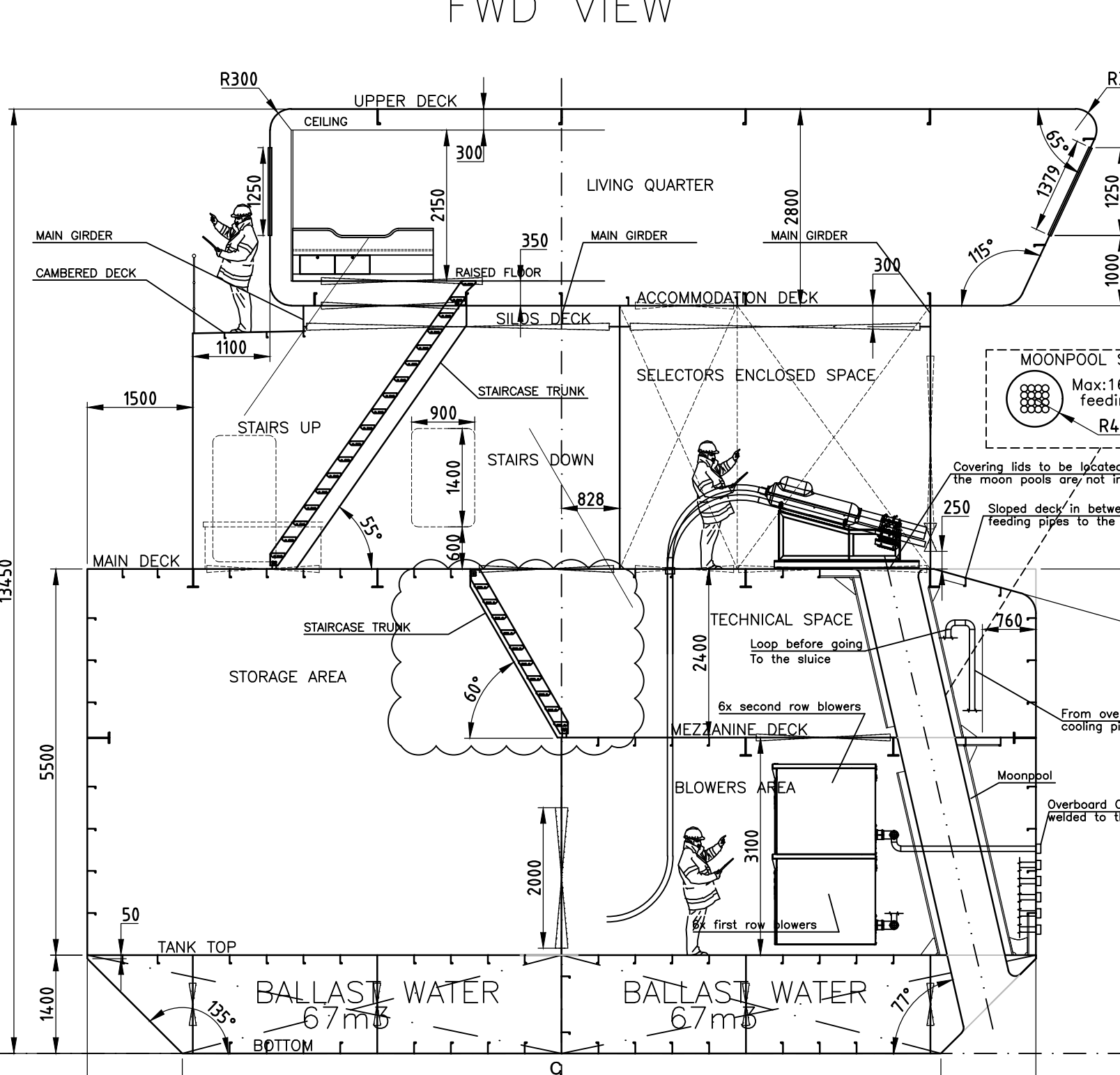

TRANSVERSAL SECTION (looking aft)
(On the way of selectors space)

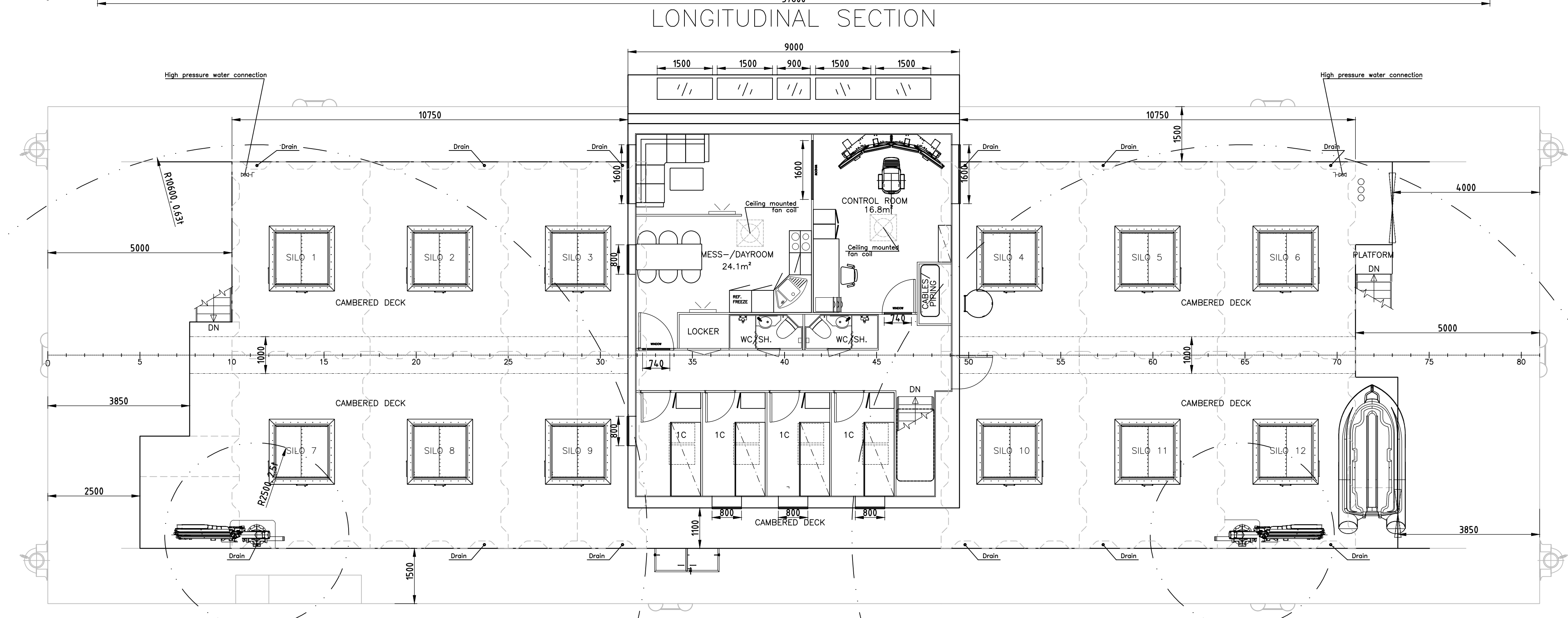

SILOS DECK

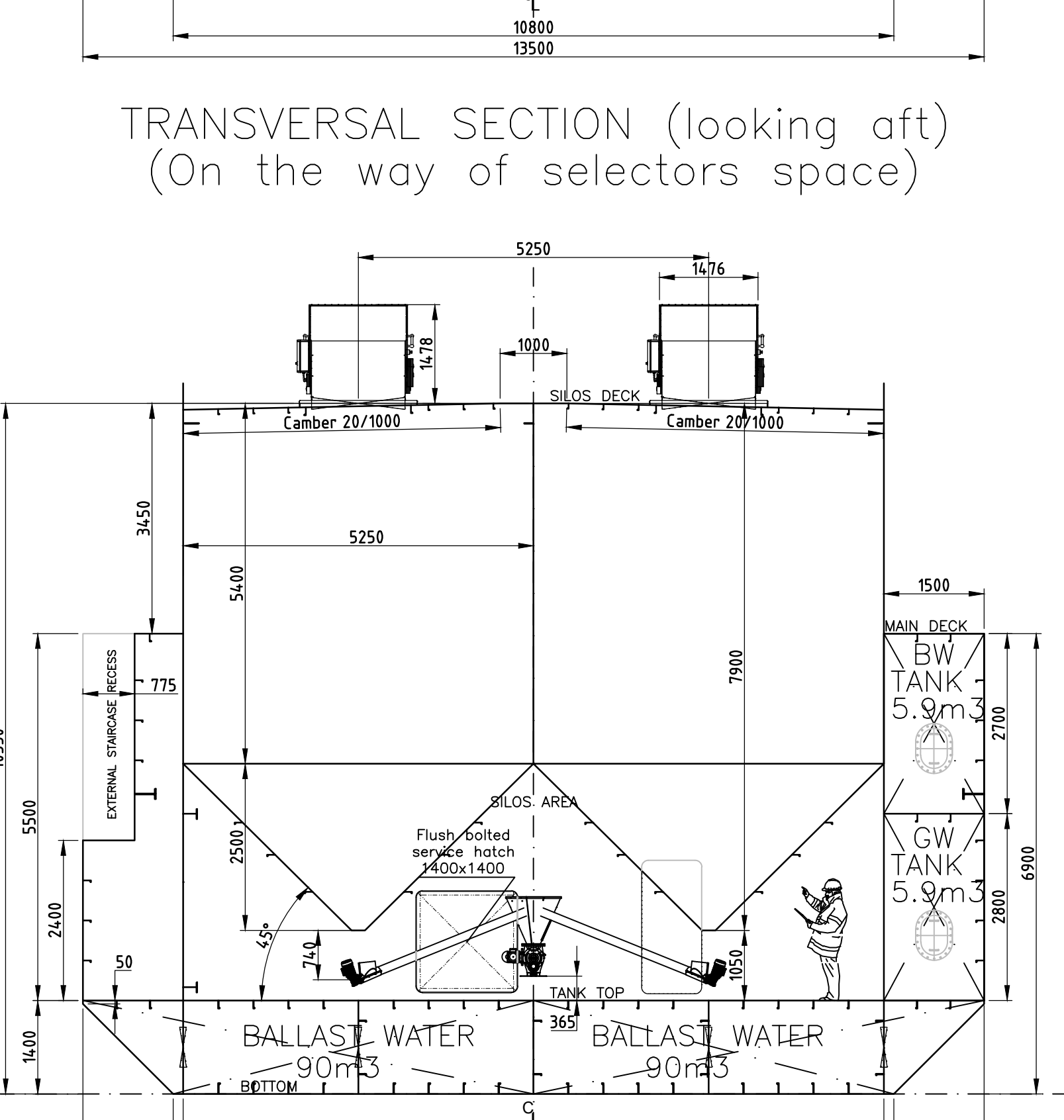

TRANSVERSAL SECTION (looking aft)
(On the way of aft silos)

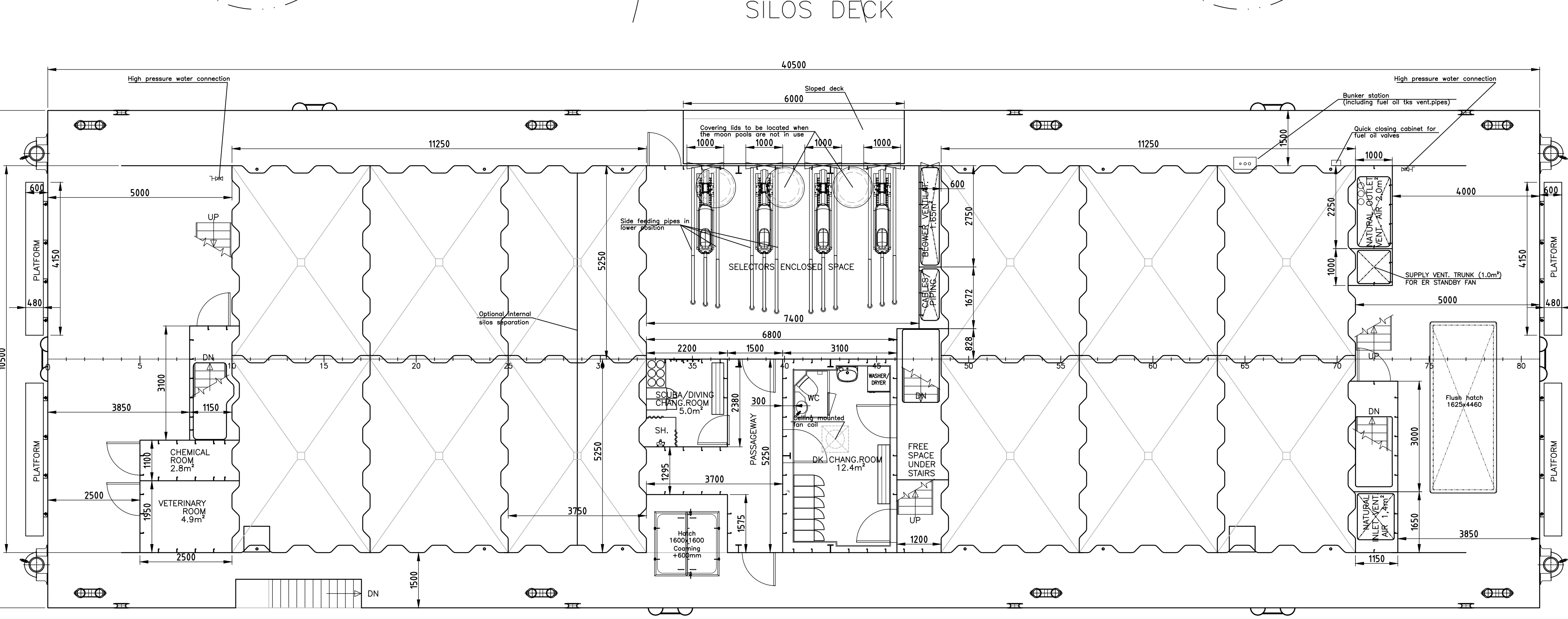

MAIN DECK

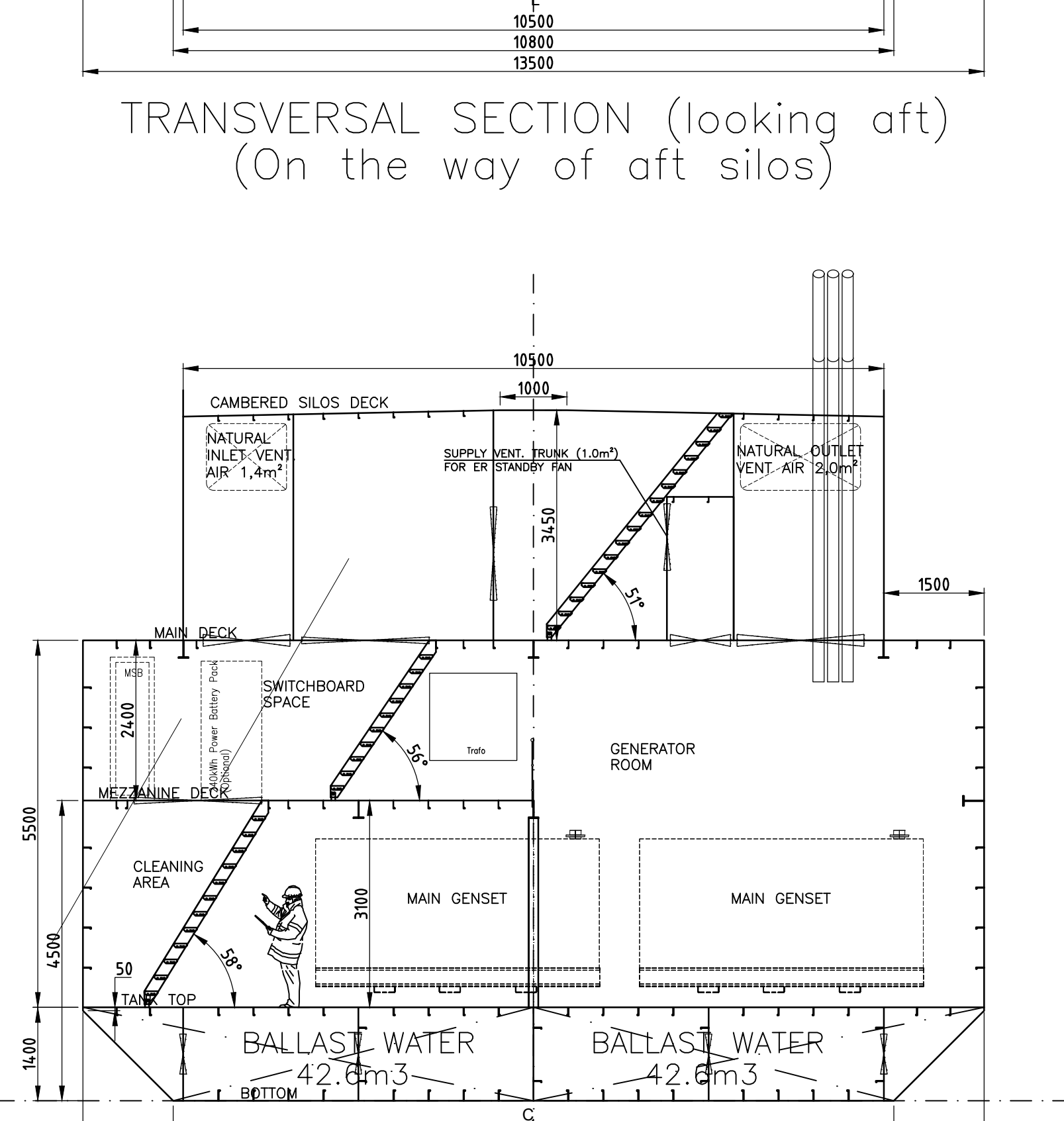

TRANSVERSAL SECTION (looking aft)
(On the way of generator room)

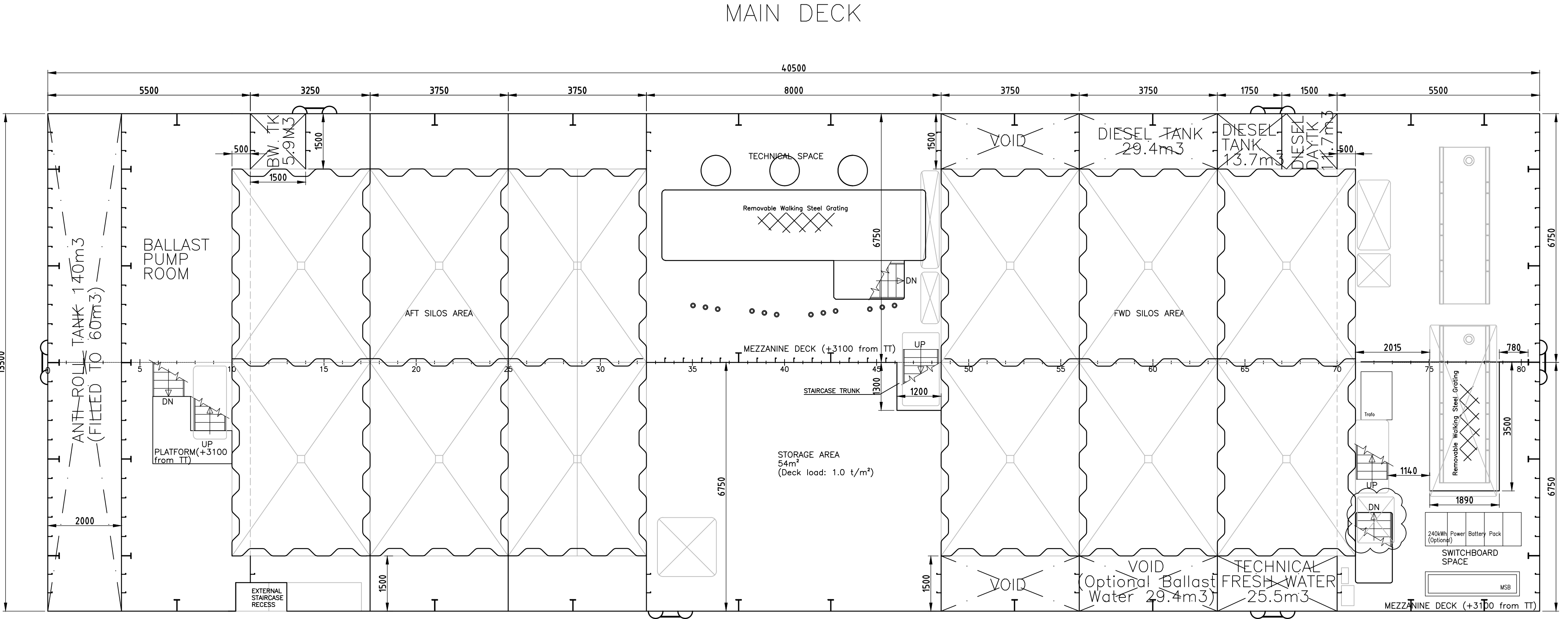

MEZZANINE DECK

MAIN DIMENSION		UNIT
LENGTH	42.5	METER
BREADTH	11.5	METER
DEPTH	6.9	METER
CRANK	4.9	METER
DECK INFO		
TOPDECK	90	M ² (10x90)
SILO DECK	236.25	M ² (23.6x90)
SILO CAPACITY		
SILO QUANTITY	12	
SILO VOLUME	Normal from 119 M ³ /516	
	Max: 125 M ³ /516	
TANK CAPACITY		
BALLAST TANK	25.5	M ³
BALLAST TANK (OPTIONAL)	M3	
BOTTOM BALLAST TANKS (6x)	M3	
FUEL TANK	54.9	M ³
BLACK OIL TANK	11.8	M ³
ANTI ROLL TANK	140 (FILLED TO 60%)	M ³
EQUIPMENT		
GENERATOR	2x330kVA	1400kVA
SHORE POWER TRAF.		
	1x600kVA	
12 BLOWERS		
NOTE:		
CRANE OUTREACH/LIFTING CAPACITY BASED ON PALFRSER PERIOD.		
HESSED BY DOORS UNDER MAIN DECK.		
SERVICE BOAT TIE STEADY 400 OR SIMILAR.		

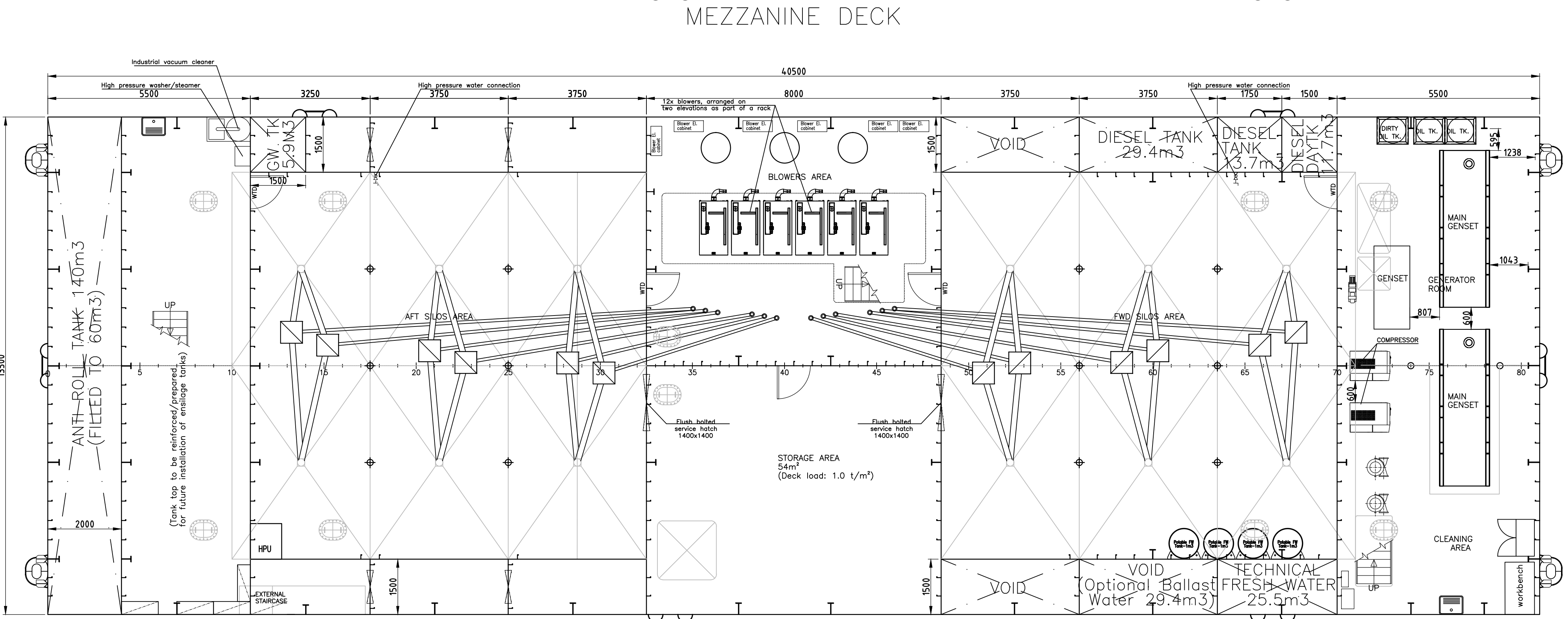

BOTTOM DECK

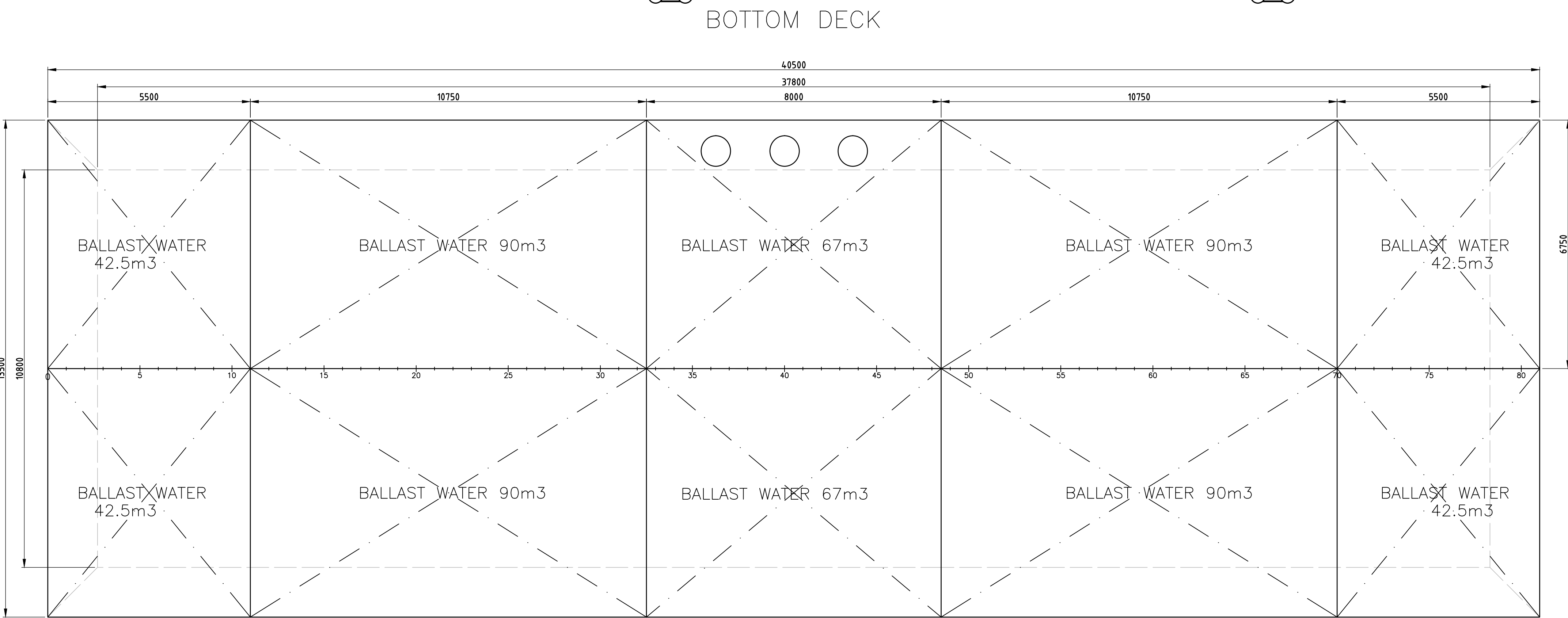

BELOW TANK TOP

- Remarks:
- Accommodation windows to be equipped with nozzles with combined fresh water+compressed air for cleaning purposes only for not reachable windows laying outward, control room side.
 - Drain from the top of living quarter to be arranged as well.
 - Freeing parts for the selectors enclosed space to be considered.
 - Raised floor (+350mm) all over the living quarter section.
 - Where height from deck to bottom of door frame is higher than 200mm, a removable/replaceable givanized step will be installed.

Rev.	Changes	Checked Date	Scale
3	GENERAL UPDATING ACIS TO STEEL OUTFITTING DRAWINGS	PET	26.03.2019
2	GENERAL UPDATING ACIS TO STRUCTURAL DRAWINGS, SIDE VESSEL	ADN	23.02.2019
1	GENERAL CHANGES UPDATING ACIS STEEL DRAWINGS	PET	02.02.2019
A	DRAWING ESTABLISHED	PET	02.02.2019

Constr/Drawn	AnMo	Scale	1:75
Date of drawing	02.12.2019	Forma	841x2035

Constr/Drawn	AnMo	Scale	1:75
Date of drawing	02.12.2019	Forma	841x2035
Page	1	Zone ref.	Unit no.
Drawing no.	2050-100-003		

Design logging as specification or Scale AD on standard of sea use ballast or other use not be used without our written consent.



GENERAL ARRANGEMENT (KSNZ DESIGN - 9001)